

14 FRISWELL DRIVE
Approximate Gross Internal Area
716.87 sq ft / 66.60 sq m

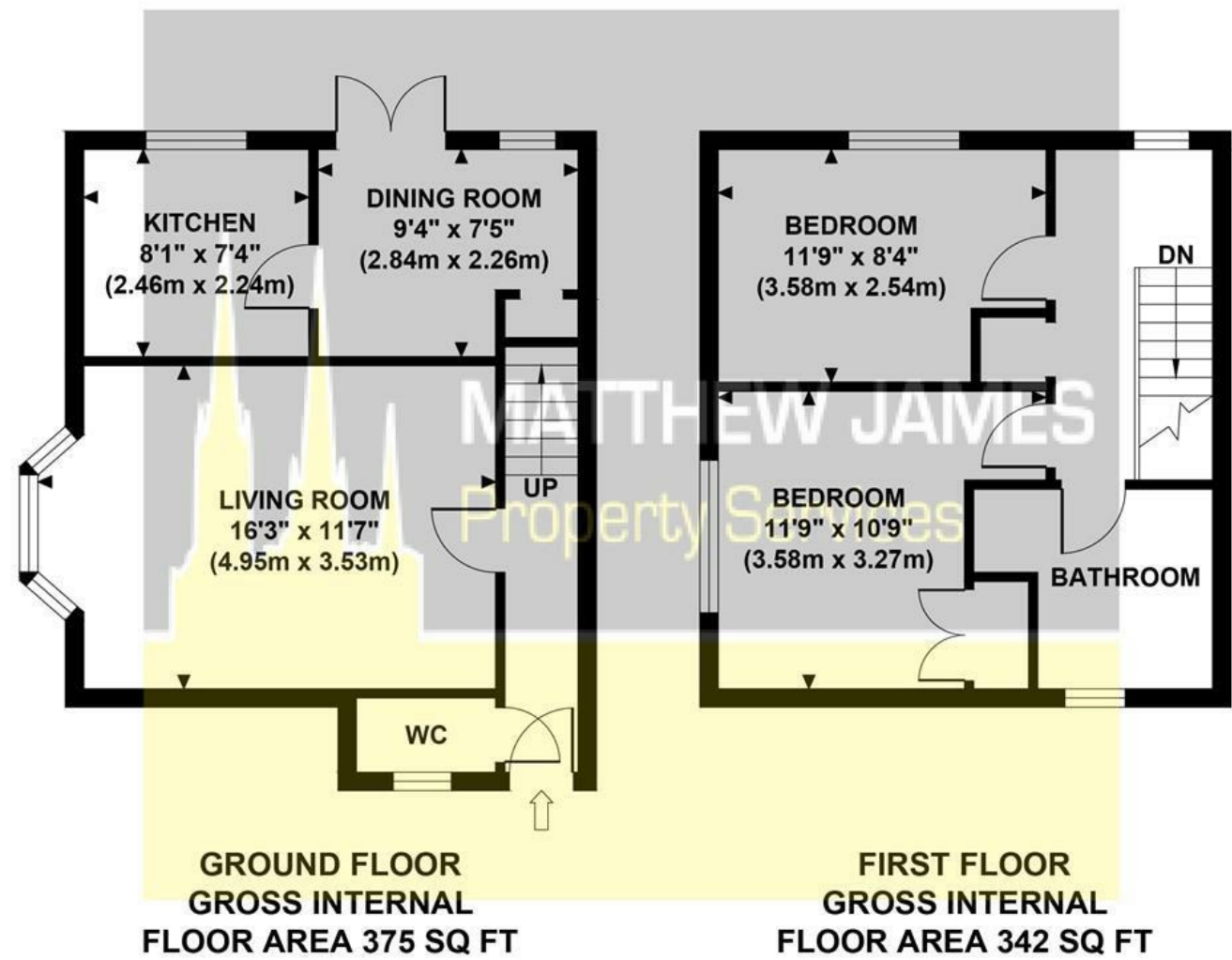

Although every attempt has been made to ensure accuracy, all measurements are approximate and no responsibility is taken for any error, omission, or mid-statement. This floor plan is for illustrative purposes only and not to scale. Measured in accordance to RICS standards.

These particulars, whilst believed to be accurate are set out as a general outline only for guidance and do not constitute any part of an offer or contract. Intending purchasers should not rely on them as statements of representation of fact, but must satisfy themselves by inspection or otherwise as to their accuracy. No person in this firm's employment has the authority to make or give any representation or warranty in respect of the property.

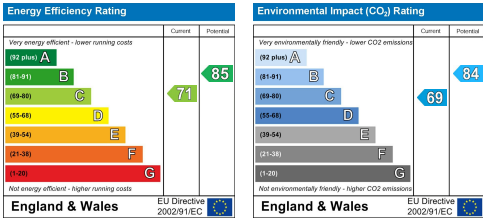

CONTACT INFORMATION

24a Warwick Row, Coventry CV1 1EY

02477 170170

info@matthewjames.uk.com

www.matthewjames.uk.com

Facebook

Twitter



MATTHEW JAMES
Property Services



14 Friswell Drive
Courthouse Green, COVENTRY CV6 7NG

NO UPWARD CHAIN... TWO DOUBLE BEDROOMS... END OF TERRACE... VERY PRIVATE LOCATION... LARGE CORNER PLOT... BEAUTIFUL THROUGHOUT... PARK VIEWS... ALLOCATED PARKING. Located in Courthouse Green, this lovely corner plot property is situated at the end of a private cul-de-sac, has allocated parking, NO UPWARD CHAIN and briefly comprises of ground floor cloakroom, living room, dining room, kitchen, two double bedrooms, larger than average family bathroom, gardens to three sides, PVCu double glazing, gas central heating and park views to the rear. Call us now to book your immediate viewing.

£169,995

14 Friswell Drive

Courthouse Green, COVENTRY CV6 7NG



- Two Double Bedrooms
- NO UPWARD CHAIN
- Park Views
- End Of A Cul-De-Sac
- Beautiful Throughout
- Allocated Parking
- Very Private
- Great Location

Front Garden	Bedroom One
Entrance Hallway	11'9 x 10'9 (3.58m x 3.28m)
Ground Floor Cloakroom	Family Bathroom
5' x 2'8 (1.52m x 0.81m)	8'7 x 7'2 (2.62m x 2.18m)
Living Room	Rear & Side Gardens
16'3 x 11'7 (4.95m x 3.53m)	Parking
Dining Room	
9'4 x 7'5 (2.84m x 2.26m)	
Kitchen	
8'1 x 7'4 (2.46m x 2.24m)	
First Floor Landing	
Bedroom Two	
11'9 x 8'4 (3.58m x 2.54m)	



Directions

